

YOUR STORAGE MANAGER!

## INSTALLATION GUIDE

2 SYSTEMS **RAIL** **FIXED**



OPEN THIS SIDE

Fully adjustable  
at all times



## A MEASURE YOUR STORAGE SPACE

- 1 – Length of walls to the nearest 1" (25 mm)
- 2 – Depth of shelves
- 3 – Height of storage space
- 4 – The chart below illustrates required heights for standard shelves

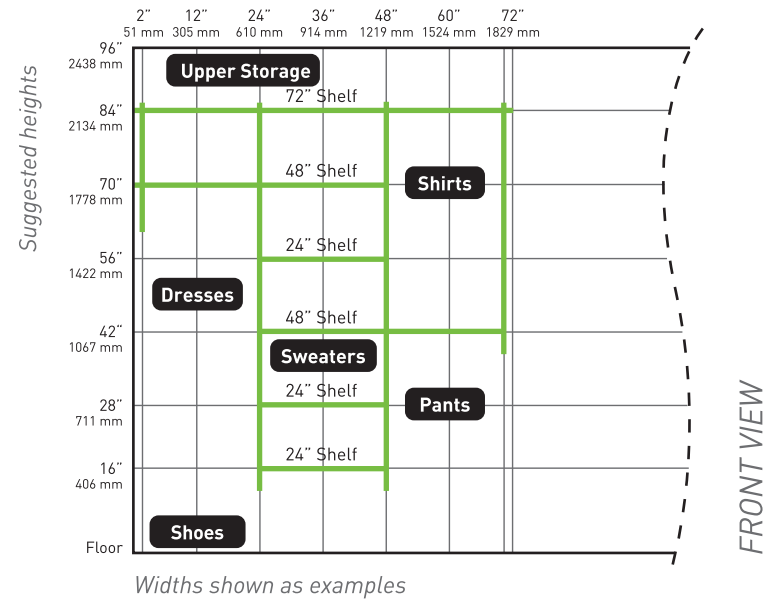

## B SELECT SHELVING



**MODEL L**  
Suitable for clothes, linens, shoes, and utility storage.  
Available in 9" (229 mm), 12" (305 mm), 16" (406 mm), and 20" (508 mm) depth.



**MODEL PS**  
Ideal for bedrooms, walk-ins and hall closets. Designed with a free and continuous sliding rod to ease hanger movement.  
Available in 12" (305 mm) and 16" (406 mm) depth



**MODEL SR**  
For clothes and linens. Ideal for bedroom and closets.  
Available in 12" (305 mm) and 16" (406 mm) depth

## C SELECT COMPONENTS



- 95-0001-4 Horizontal Mounting Rail 48" (1219 mm)
- 95-0001-6 Horizontal Mounting Rail 72" (1829 mm)
- 95-0002-1 Upright (double) 12" (305 mm)
- 95-0002-2HD Upright (double) 24" (610 mm)
- 95-0002-4HD Upright (double) 48" (1219 mm)
- 95-0002-6HD Upright (double) 72" (1829 mm)
- 95-0003-12D Adjustable Shelf Bracket 12" (305 mm)
- 95-0003-16D Adjustable Shelf Bracket 16" (406 mm)
- 95-0004 Holding bracket for rod #04-0351
- 04-00351 Closet rod 72" x 1" dia (1829 mm x 25 mm)
- 95-0005 Hardware Pack for Rail Installation
- 97-0071 1" dia. (25 mm) end cap for closet rod

## D INSTALLATION



- 1 INSTALL HORIZONTAL RAIL TO THE WALL**
  - Ensure rail is level
  - Fix rail to studs
  - Rail available in 48" (1219 mm) and 72" (1829 mm) lengths
- 2 HANG UPRIGHTS TO RAIL**
  - Position uprights a maximum of 30" (760 mm) apart and no more than 6" (150 mm) from ends
  - Uprights available in 12" (305 mm), 24" (610 mm), 48" (1220 mm) and 72" (1829 mm) lengths
- 3 FASTEN UPRIGHTS TO WALL**
- 4 INSERT BRACKETS**
  - Insert brackets to the desired height
  - Brackets available in 12" (305 mm) and 16" (406 mm) lengths
  - Use bracket that fits with your shelf selection
- 5 INSERT SHELVES ON BRACKETS** (see illustration)
- 6 POSITION SHELVING TO FIT YOUR NEEDS**

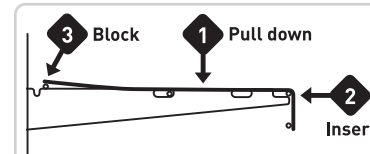

YOUR STORAGE MANAGER!

## INSTALLATION GUIDE

2 SYSTEMS **RAIL** **FIXED**



OPEN THIS SIDE

MADE IN CANADA



225, Industrielle  
Sainte-Marguerite  
Québec, Canada  
G0S 2X0

T 418 935-3939  
T 1 800 463-1434  
F 418 935-3622

[www.permafil.com](http://www.permafil.com)

225, Industrielle  
Sainte-Marguerite  
Québec, Canada  
G0S 2X0

T 418 935-3939  
T 1 800 463-1434  
F 418 935-3622

[www.permafil.com](http://www.permafil.com)



